

M&E Installation

Gorton Community Hub

Empowering communities with expert M&E Solutions, Quartzelec's latest triumph at Gorton Community Hub sees a full M&E installation which included HV/LV power and systems, HVAC, drainage, lighting schemes and security systems

MORGAN SINDALL | CONSTRUCTION | MANCHESTER, UK

Our Customer's Challenge

The Gorton area of Manchester underwent a transformation with multiple investments aimed at improving the local community's social, economic and physical well-being. The Gorton Community Hub, a multi-use space offering a range of services, was built to house a GP practice, NHS community health teams, pharmacy, Jobcentre Plus and other support services. Quartzelec would be responsible for the full M&E installation including several key elements such as drainage, heating, ventilation, lighting and security systems.

The Quartzelec Solution

Quartzelec's approach was to participate in the project's early stages, providing extensive technical support to the main contractor throughout the council's consulting process. And, prior to contract award, Quartzelec also assisted with the detailed project scope which managed all stakeholders' expectations including project objectives, deliverables and constraints as well as demonstrating commitment to the development through community engagement.

Providing design consulting services, technical support as well as collaborating with other disciplines to develop a BIM level 2 design solution ensured the final design met the project specification, budget constraints and quality standards.

Communication is key and throughout the construction phase weekly progress meetings and daily site briefings were held to discuss project progress, labour requirements, health & safety, procurement as well as any daily challenges.

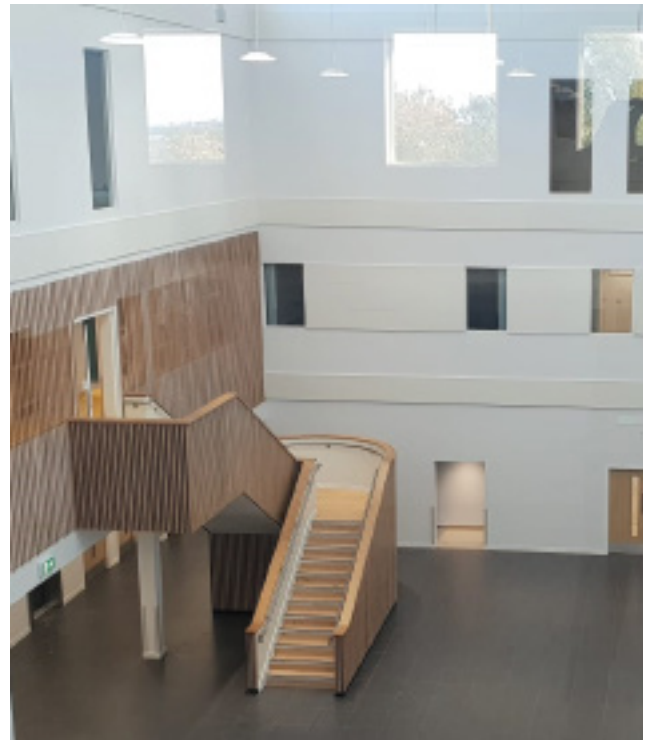

The Quartzelec Solution (continued)

Enlisting the skills and services of local labour and supply chain (with operatives living within a 20-mile radius) were crucial project deliverables that Quartzelec embraced throughout. Commitment to the development was also demonstrated through participating in multiple community engagement events including assisting with the refurbishment of a local community centre.

Quartzelec's contribution to sustainability performance included the use of innovative technologies wherever possible including; water leak detection technology, flow control devices, Bipolar Ionisation units, solar panels, and energy-saving LED lighting.



Project Success Factors

A detailed M&E scheme, Quartzelec played a significant role in the project through:

- M&E Installation (including; lighting, security, solar, PV, HVAC and BMS)
- Ensuring the target completion of 9 months achieved
- Commitment to quality evident with all works signed off and minimal defects reported since handover
- Innovative use of technologies to support BREEAM rating with the Project in-line to receive a BREEAM rating of 'Excellent'
- Local labour and supply chain considered a priority throughout



“ Quartzelec were an integral part of the project delivery team and adopted a collaborative approach throughout the life cycle of the project, from pre-construction through into post-handover aftercare. The quality of their work on site was excellent as was their willingness to work with us when issues arose. Their input and approach was key to ensuring that the Gorton Hub project was delivered on time and that the client was delighted with the end product - Paul Waite, Project Manager at Manchester City Council



The construction process has created £16m Social Value in the local area, a return on investment of 78% of the project value.